

54 Kensington St, Yo23 1JA floor plan

Outside area 18.5m approx. inc shed (1.5x2m)
Ground floor area 30 mts approx
First floor area 24 mts approx

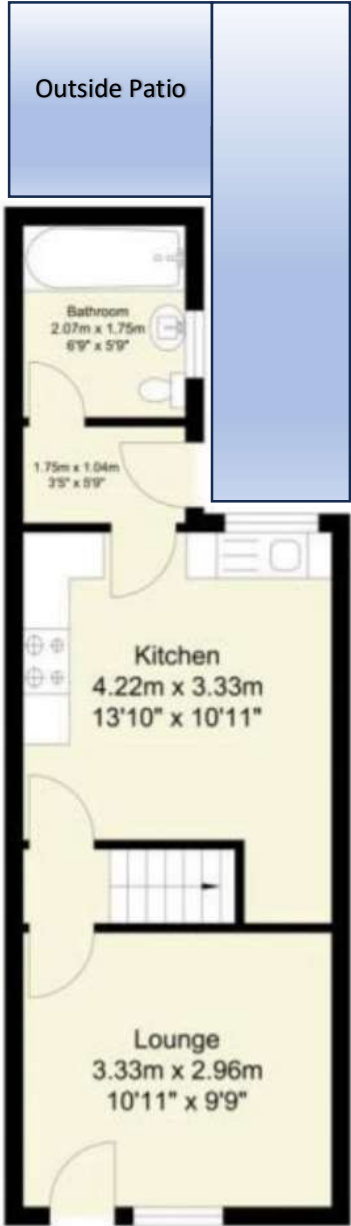

GROUND FLOOR

Approximate Floor Area 30.05 sq. m (323.45 sq. ft.)

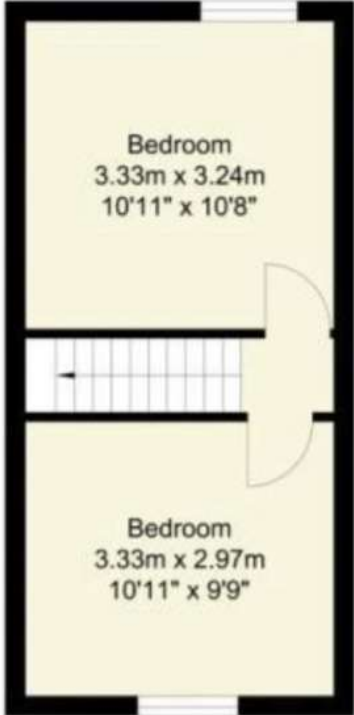

FIRST FLOOR

Approximate Floor Area 24.24 sq. m (260.91 sq. ft.)